



Multi-Residential
SUPPLY Ltd

CABINETS



226-289-2869 • multiresidentialsupply.com

Cabinetsmith
style • quality • affordability

HUNTSVILLE
SMOOTH WHITE CABINETS PROGRAM



KEY FEATURES

**QUICK SHIPPING + PRE-ASSEMBLY
MEANS A NEW KITCHEN IN 2 WEEKS**

The Huntsville White Shaker program offers a complete line up of ready-to-install, Canadian made cabinetry that is designed to suit any style and living space. Its shaker styling paired with a white finish gives you the look and feel of a painted door, without any of the added cost. Using the included layout grid and cabinet list, start designing your new space today.

Canadian Made

All of our cabinetry is manufactured in Barrie, Ontario, Canada.

Fully Assembled

Our cabinetry is built and shipped complete, ready to install.

10-Year Warranty

You have peace of mind with our 10-year limited warranty.



White Shaker Doors

- Timeless shaker style
- Paint-like finish
- Durable termofoil

- A** Reinforced support rail
- B** DIY-Friendly adjustable legs
- C** Soft close doors & drawers
- D** Glue & dowel construction

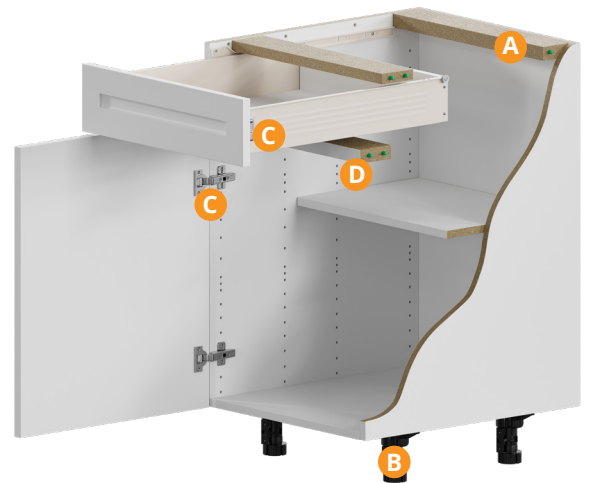

**Exposed base end cabinets will require repositioning of legs to accommodate toe-kick return or purchase of base end panel.*



HUNTSVILLE SHAKER WHITE



226-289-2869 • sales@multiressupply.com • multiresidentialsupply.com

BASE CABINETS

All base cabinets are built to 34^{1/2}" comfort height. They feature a 5" false front or drawer bank, and adjustable legs.

SINGLE CABINET

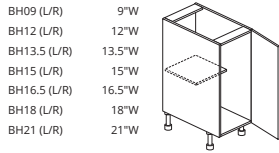

- BH09 (L/R) 9"W
- BH12 (L/R) 12"W
- BH13.5 (L/R) 13.5"W
- BH15 (L/R) 15"W
- BH16.5 (L/R) 16.5"W
- BH18 (L/R) 18"W
- BH21 (L/R) 21"W

DOUBLE CABINET

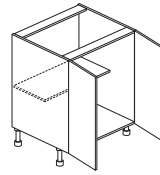

- BH24 24"W
- BH27 27"W
- BH30 30"W
- BH33 33"W
- BH36 36"W

SINGLE DRAWER CABINET

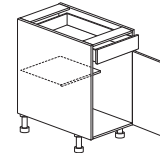

- BD12 (L/R) 12"W
- BD13.5 (L/R) 13.5"W
- BD15 (L/R) 15"W
- BD16.5 (L/R) 16.5"W
- BD18 (L/R) 18"W
- BD21 (L/R) 21"W

DOUBLE DOOR / DRAWER BASE

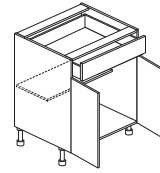

- BD24 24"W
- BD27 27"W
- BD30 30"W
- BD33 33"W
- BD36 36"W

SINK BASE

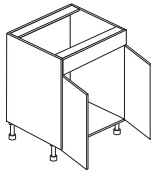

- SB24 24"W
- SB27 27"W
- SB30 30"W
- SB33 33"W
- SB36 36"W

APRON SINK

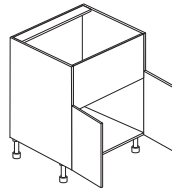

- SBAP 30"W
- SBAP33 33"W
- SBAP36 36"W

3-DRAWER BANK

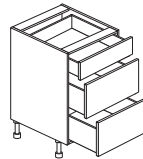

- DB12-3 12"W
- DB15-3 15"W
- DB18-3 18"W
- DB21-3 21"W
- DB24-3 24"W
- DB27-3 27"W
- DB30-3 30"W
- DB33-3 33"W

4-DRAWER BANK

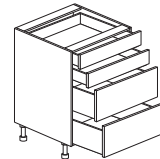

- DB12-4 12"W
- DB15-4 15"W
- DB18-4 18"W

MICROWAVE CABINET

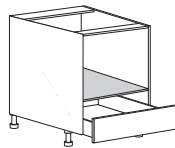

- BMD24 24"W
- BMD30 30"W

COOKTOP BASE

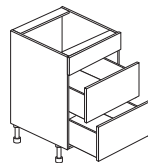

- BC30 30"W
- BC33 33"W

12" D SINGLE CABINET

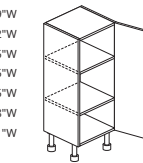

- BFH0912 (L/R) 9"W
- BFH1212 (L/R) 12"W
- BFH13.512 (L/R) 13.5"W
- BFH1512 (L/R) 15"W
- BFH16.512 (L/R) 16.5"W
- BFH1812 (L/R) 18"W
- BFH2112 (L/R) 21"W

12" D DOUBLE CABINET

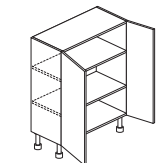

- BFH2412 24"W
- BFH2712 27"W
- BFH3012 30"W
- BFH3312 33"W
- BFH3612 36"W

CORNER CABINETS

EASY REACH CORNER

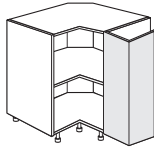

- BE33 (L/R) 33"W
- BE36 (L/R) 36"W

EASY REACH CORNER OFFSET

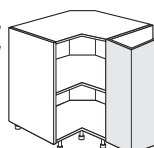

- BE33-36 (L/R) 33"W
- BE36-33 (L/R) 36"W

BLIND CORNER 39" - 48"

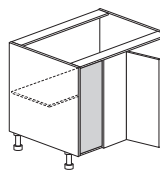

- BBH39 (3" pull) L/R 39"W
- BBH42 (6" pull) L/R 42"W
- BBH45 (9" pull) L/R 45"W
- BBH48 (12" pull) L/R 48"W

BLIND CORNER 51" - 63"

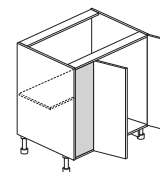

- BBH51 (2" pull) L/R 51"W
- BBH54 (6" pull) L/R 54"W
- BSB60 (12" pull) L/R 60"W
- BSB63 (15" pull) L/R 63"W

TRANSITIONAL END BASE

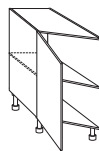

- BTE12 (L/R) 12"W

ANGLED SINK CORNER

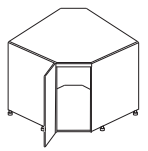

- B5A36(L/R) 36"W

Cab	Wall Space to Fill	Door Size	Fill Req.	Min Pull	Max Pull
BBH39	39-42"	12"	3"	3"	5"
BBH42	42-44"	15"	3"	6"	8"
BBH45	45-47"	18"	3"	9"	11"
BBH48	48-50"	21"	3"	12"	14"

Cab	Wall Space to Fill	Door Size	Fill Req.	Min Pull	Max Pull
BBH51	51-53"	2X 12"	3"	3"	5"
BBH54	54-56"	2X 13.5"	3"	6"	8"
BSB60	60-62"	2X 16.5"	3"	12"	14"
BSB63	63-65"	2X 18"	3"	15"	17"

OVEN AND PANTRY

24" D | 84,90,94" H BROOM CABINET

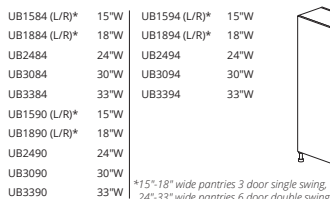

- UB1584 (L/R)* 15"W
- UB1884 (L/R)* 18"W
- UB2484 24"W
- UB3084 30"W
- UB3384 33"W
- UB1590 (L/R)* 15"W
- UB1890 (L/R)* 18"W
- UB2490 24"W
- UB3090 30"W
- UB3390 33"W

*15"-18" wide pantries 3 door single swing.
24"-33" wide pantries 6 door double swing

24" D | 84,90,94" H PANTRY CABINET

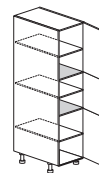

- UP1584 (L/R)* 15"W
- UP1884 (L/R)* 18"W
- UP2484 24"W
- UP3084 30"W
- UP3384 33"W
- UP1590 (L/R)* 15"W
- UP1890 (L/R)* 18"W
- UP2490 24"W
- UP3090 30"W
- UP3390 33"W

*15"-18" wide pantries 3 door single swing.
24"-33" wide pantries 6 door double swing

24" D | 84,90,94" H UTILITY HUTCH

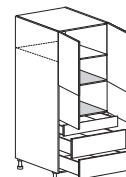

- UH1894 (L/R)* 18"W
- UH2494 24"W
- UH3094 30"W
- UH3394 33"W
- UH1890 (L/R)* 18"W
- UH2490 24"W
- UH3090 30"W
- UH3390 33"W

*18" wide pantries 2 door single swing, 24"-33" wide pantries 4 door double swing

24" D | 84,90,94" H OVEN CABINET

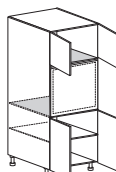

- OS3384 33"W
- OS3390 33"W
- OS3394 33"W

24" D | 84,90,94" H DOUBLE OVEN CABINET

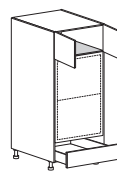

- OD3384 33"W
- OD3390 33"W
- OD3394 33"W



WALL CABINETS

24" DEEP WALL CABINETS

12" H DOUBLE DOOR WALL

W3012-24 30"W
W3312-24 33"W
W3612-24 36"W

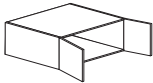

15" H DOUBLE DOOR WALL

W2415-24 24"W
W2715-24 27"W
W3015-24 30"W
W3315-24 33"W
W3615-24 36"W

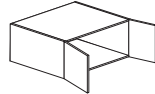

18" H DOUBLE DOOR WALL

W2418-24 24"W
W3018-24 30"W
W3318-24 33"W
W3618-24 36"W

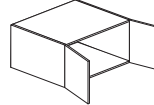

21" H DOUBLE DOOR WALL

W3021-24 30"W
W3321-24 33"W
W3621-24 36"W

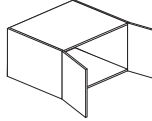

25" H DOUBLE DOOR WALL

W3025-24 30"W
W3325-24 33"W
W3625-24 36"W

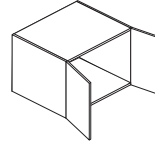

12" DEEP WALL CABINETS

12" H DOUBLE DOOR WALL

W3012 30"W
W3312 33"W
W3612 36"W

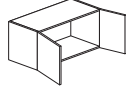

15" H DOUBLE DOOR WALL

W2415 24"W
W2715 27"W
W3015 30"W
W3315 33"W
W3615 36"W

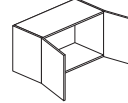

18" H DOUBLE DOOR WALL

W2418 24"W
W3018 30"W
W3318 33"W
W3618 36"W

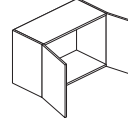

21" H DOUBLE DOOR WALL

W2421 24"W
W3021 30"W
W3321 33"W
W3621 36"W

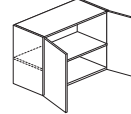

25" H SINGLE DOOR WALL

W1225 (L/R) 12"W
W1525 (L/R) 15"W
W1825 (L/R) 18"W
W2125 (L/R) 21"W



25" H DOUBLE DOOR WALL

W2425 24"W
W2725 27"W
W3025 30"W
W3325 33"W
W3625 36"W

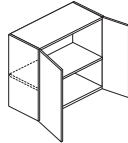

30" H SINGLE DOOR WALL

W0930 (L/R) 9"W
W1230 (L/R) 12"W
W13.530 (L/R) 13.5"W
W1530 (L/R) 15"W
W16.530 (L/R) 16.5"W
W1830 (L/R) 18"W
W2130 (L/R) 21"W

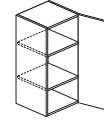

30" H DOUBLE DOOR WALL

W2430 24"W
W2730 27"W
W3030 30"W
W3330 33"W
W3630 36"W

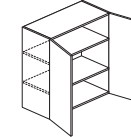

36" H SINGLE DOOR WALL

W0936 (L/R) 9"W
W1236 (L/R) 12"W
W13.536 (L/R) 13.5"W
W1536 (L/R) 15"W
W16.536 (L/R) 16.5"W
W1836 (L/R) 18"W
W2136 (L/R) 21"W

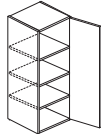

36" H DOUBLE DOOR WALL

W2436 24"W
W2736 27"W
W3036 30"W
W3336 33"W
W3636 36"W

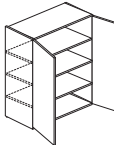

40" H SINGLE DOOR WALL

W0940 (L/R) 9"W
W1240 (L/R) 12"W
W13.540 (L/R) 13.5"W
W1540 (L/R) 15"W
W16.540 (L/R) 16.5"W
W1840 (L/R) 18"W
W2140 (L/R) 21"W

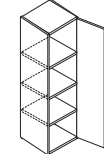

40" H DOUBLE DOOR WALL

W2440 24"W
W2740 27"W
W3040 30"W
W3340 33"W
W3640 36"W

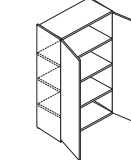

15" H MICROWAVE SHELF

CS-MS2415 24"W

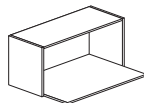

30" H MICROWAVE WALL

WMS2430 24"W

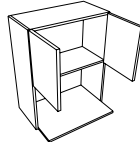

30,36,40" H WALL CORNER

CS-WESC1206-30 12"W
CS-WESC1206-36 12"W
CS-WESC1206-40 12"W

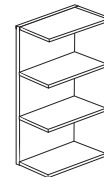

WALL CORNER CABINETS

30,36,40" H ANGLE CORNER WALL

WA2430 (L/R) 12"D
WA2436 (L/R) 12"D
WA2440 (L/R) 12"D

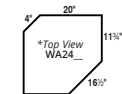

30,36,40" H SINGLE BLIND CORNER

WB2430 (L/R) 24"W
WB2730 (L/R) 27"W
WB3030 (L/R) 30"W
WB3330 (L/R) 33"W
WB3630 (L/R) 36"W

WB2436 (L/R) 24"W
WB2736 (L/R) 27"W
WB3036 (L/R) 30"W
WB3336 (L/R) 33"W
WB3636 (L/R) 36"W

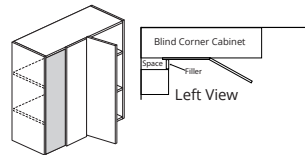

PANELS AND MOULDING

30,40,96,97" H FILLER STRIP

CS-97X6FB-WH 6"W
CS-97X9FB-WH 9"W
CS-30FILLER-WSM 3"W
CS-40FILLER-WSM 3"W
CS-96FILLER-WSM 3"W



84,94" H FRIDGE PANELS

CS-FRIDGE84-WH 24"D
CS-FRIDGE9430-WH 30"D



END PANELS

CS-WEP1230-WH 12"H 30"W
CS-WEP1236-WH 12"H 36"W
CS-WEP1240-WH 12"H 40"W
CS-WEP1530-WH 15"H 30"W
CS-WEP1536-WH 15"H 36"W
CS-WEP1540-WH 15"H 40"W
CS-ISLAND48-WH 48"H 48"W
CS-DWPANEL3625-WH 36"H 25"W



CROWN AND MOULDING

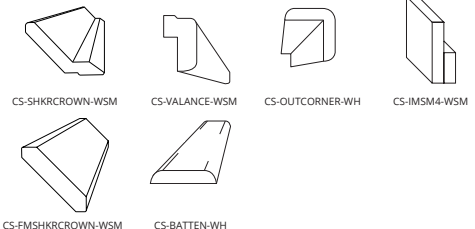

96" H TOE KICK

CS-96TK-WH 4 1/2"W



DESIGN GRID

Use the grid below to layout your new space.
Give your design to us to get started.

Measuring Up Your Layout

Remember to always measure from the outside edge of the door and window trim. Ensure you include all accurate wall measurements.

1. Using the grid supplied to sketch an overhead view of your space. Start at the 0,0 position (upper left corner) and draw outward.
2. Start in the corner of the room and measure the overall dimension of your walls. Write the measurement, in inches, on the shaded area of the grid.
3. Mark the location of all windows and doors noting their width and height including trim.
4. Draw in major appliances noting their outside width, height and depth.
5. Mark the position of plumbing, gas and electrical outlets.
6. Draw in your cabinets and label each one with their corresponding item #.

Indicate Ceiling Height. (Ft/in.) _____

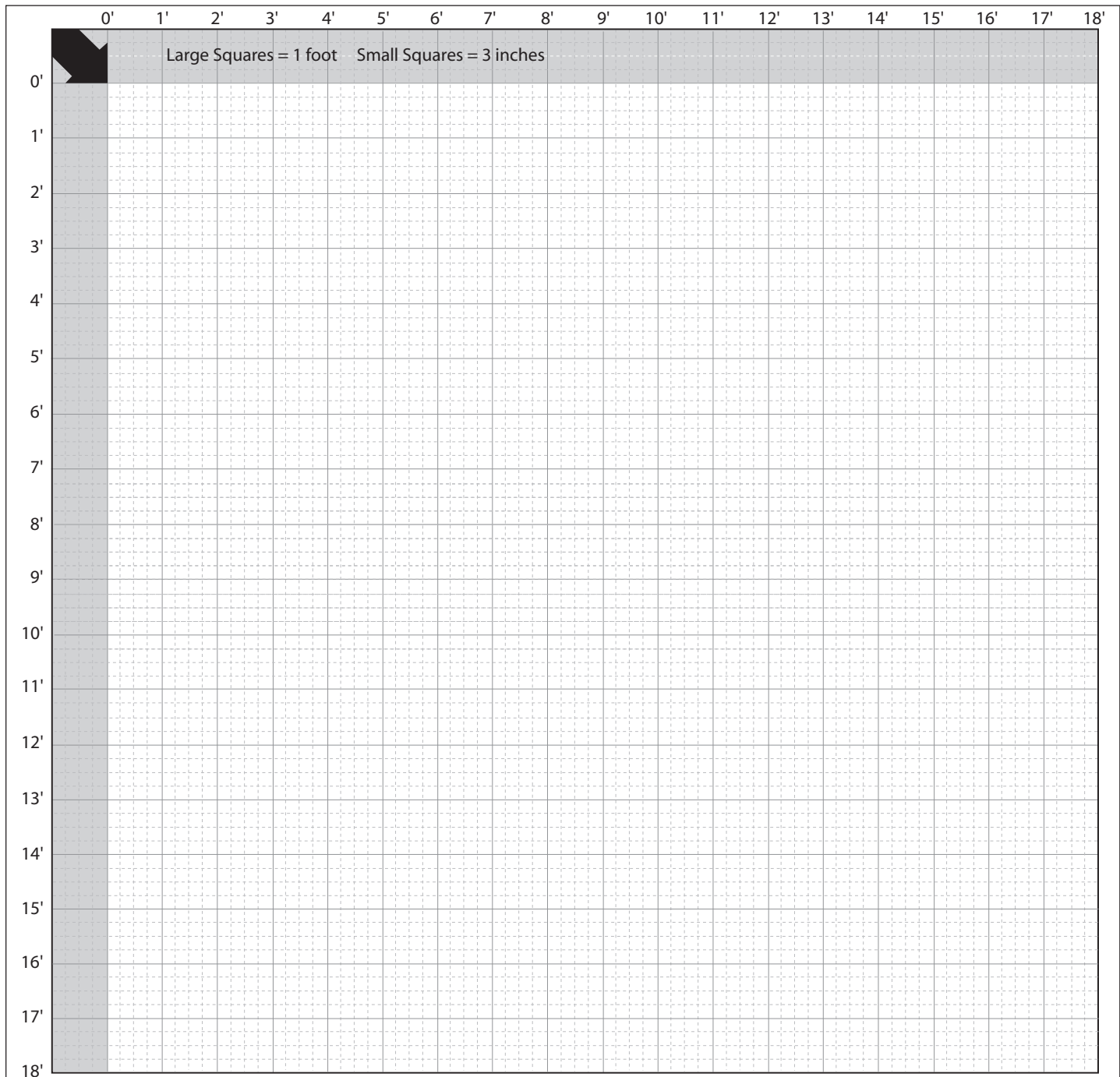



A national association that strives to promote the interests and conserve the rights of manufacturers of kitchen cabinets, bathroom vanities and related millwork, as well as our supplies and dealers, throughout Canada.



Ontario Made brings together manufacturers and makers, retailers and consumers to celebrate and promote the many world-class products that are made right here. We are dedicated to helping consumers identify Ontario-made products, celebrate what is Ontario-made and support the purchase of Ontario-made products.



Well Made Here is a federally chartered non-profit organization. Our commitment is to encourage the purchase of quality building materials and other items manufactured in Canada intended for the residential market.







MAKING YOUR INVESTMENT PROPERTY GROW